

## Globe Valve

Fig. 6123

### PN16/PN25/Class125/Class250

**Valve Standards:** Complies with BS EN 13789 / MSS SP-85.

#### ◆ Working Pressure and Temperature

Working pressure PN16/PN25/Class125/Class250.

Temperature from -10°C to 120°C.

#### ◆ Flange Types

EN1092-2 PN10/PN16/PN25, ANSI B16.1 Class125,

ANSI B16.2 Class250, BS10 Table D/E, JIS 10K/16K.



#### ◆ Materials Specifications

Part Name	Materials	EN Spec.	ASTM Spec.
Body*	Cast Iron	EN-JL1040	A126 Class B
Bonnet*	Cast Iron	EN-JL1040	A126 Class B
Body Trim	Bronze	EN1982 CC491K	B62 C83600
Disc Trim	Bronze	EN1982 CC491K	B62 C83600
Disc*	Cast Iron	EN-JL1040	A126 Class B
Stem	Stainless Steel	BS970 420S37	AISI 420
Packing	Graphite	Non-asbestos	Non-asbestos
Gasket	Graphite	Non-asbestos	Non-asbestos
Yoke Bushing	Brass	CuZn39Pb3	B16 C36000
Handwheel	Cast Iron	EN-JL1040	A126 Class B

**Note\*:** Body, bonnet & disc materials are ductile iron when valve pressure rating is PN25/Class250.

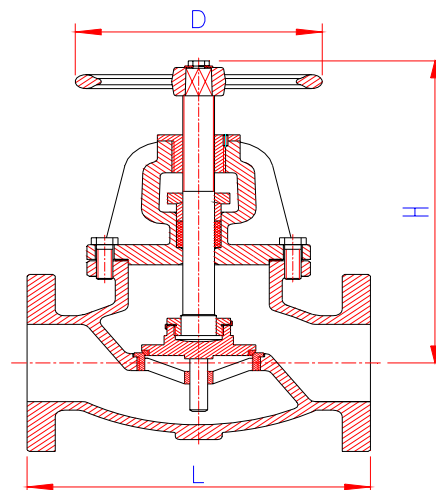

#### ◆ Dimensions (mm)

Size	50/2"	65/2.5"	80/3"	100/4"	125/5"	150/6"	200/8"	250/10"	300/12"
L	203	216	241	292	330	356	495	622	698.5
H(Open)	295	336	345	389	425	511	580	720	859
D	190	190	190	305	305	305	305	400	457

## Globe Valve

Fig. 6125

### PN16

- ◆ **Valve Standard:** Complies with DIN3356.
- ◆ **Face to face dimensions:** DIN 3202 Series F1.
- ◆ **Working Pressure and Temperature**  
Working pressure PN16.  
Temperature from -10°C to 120°C.
- ◆ **Flange Types**  
EN1092-2 PN10/PN16, other flange types are available.



### Materials Specifications

Part Name	Materials	EN Spec.	ASTM Spec.
Body	Cast Iron	EN-JL1040	A126 Class B
Bonnet	Cast Iron	EN-JL1040	A126 Class B
Body Trim	Stainless Steel	BS970 304S15	AISI 304
Disc Trim	Stainless Steel	BS970 304S15	AISI 304
Disc	Cast Iron	EN-JL1040	A126 Class B
Stem	Stainless Steel	17440X20Cr13	AISI 420
Packing	Graphite	Non-asbestos	Non-asbestos
Gasket	Graphite	Non-asbestos	Non-asbestos
Yoke Bushing	Brass	CuZn39Pb3	B16 C36000
Handwheel	Cast Iron	EN-JL1040	A126 Class B

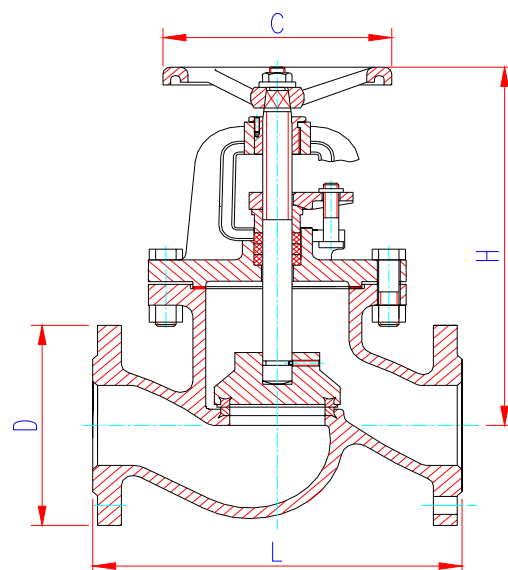

### Dimensions (mm)

Size	15	20	25	32	40	50	65	80	100	125	150	200	250	300
L	130	150	160	180	200	230	290	310	350	400	480	600	730	850
D	95	105	115	140	150	165	180	200	220	250	285	340	405	460
H	155	160	180	220	230	250	260	340	377	422	485	568	645	760
C	100	100	100	120	140	140	200	200	240	280	320	360	400	400